

FOR LEASE

3536 S. Higuera St, Ste 240 & 250
Tenwise Park
San Luis Obispo

ROSSETTI
COMPANY
COMMERCIAL REAL ESTATE



FEATURES

Comments: End cap retail/showroom space with great visibility off South Higuera. Over 17,000 cars per day travel in front of this building. Includes storefront and rear loading dock. Perfect for a retail showroom, or an online business with a warehouse requirement. No needs a retail presence.

Location: 3536 S. Higuera Street, Stes 240 & 250, South San Luis Obispo

Price: \$1.15/SF, NNN (Approx. NNN \$0.35)

Type: Retail/Showroom

Size: 3,340 sq. ft.

Zoning: CS

Parking: 1/300 SF



CONTACT

Preston Thomas, SIOR
805.544.3900 office
805.544.3922 fax
preston@rossetticompany.com
BRE Lic. #01378821

1301 Chorro Street | San Luis Obispo, CA 93401 | tel 805.544.3900 | www.rossetticompany.com

Information contained herein has been obtained from the owner of the property or from other sources deemed reliable. We have no reason to doubt its accuracy, but we do not guarantee it.



SITE PLAN

Tenwise Park
San Luis Obispo

ROSSETTI COMPANY

COMMERCIAL REAL ESTATE

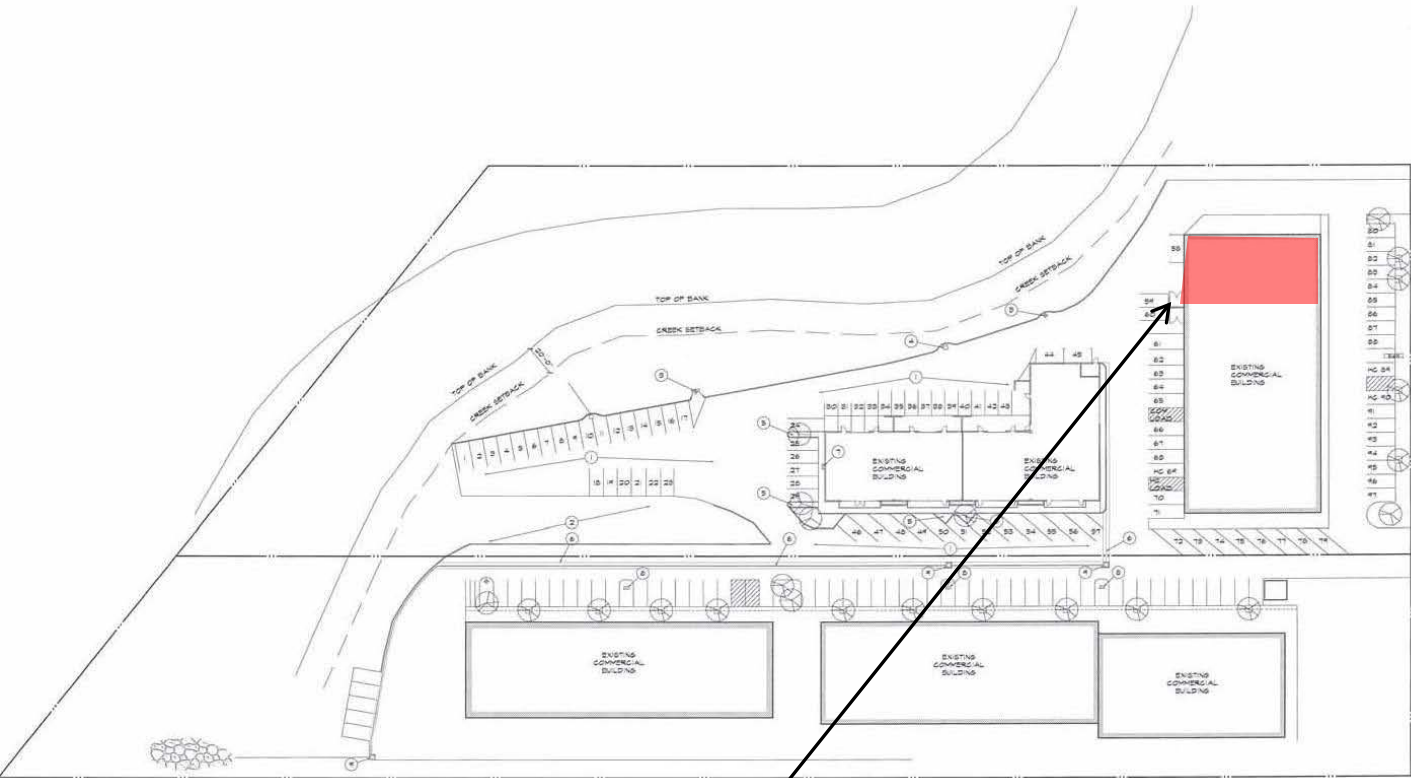

Subject Property

Roll-Up Door

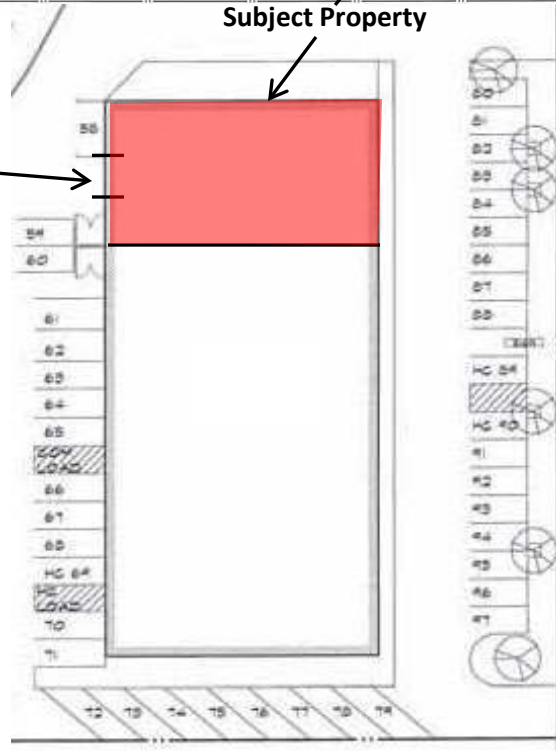

1301 Chorro Street | San Luis Obispo, CA 93401 | tel 805.544.3900 | www.rossetticompany.com

Information contained herein has been obtained from the owner of the property or from other sources deemed reliable. We have no reason to doubt its accuracy, but we do not guarantee it.



LOCATION

Tenwise Park
San Luis Obispo

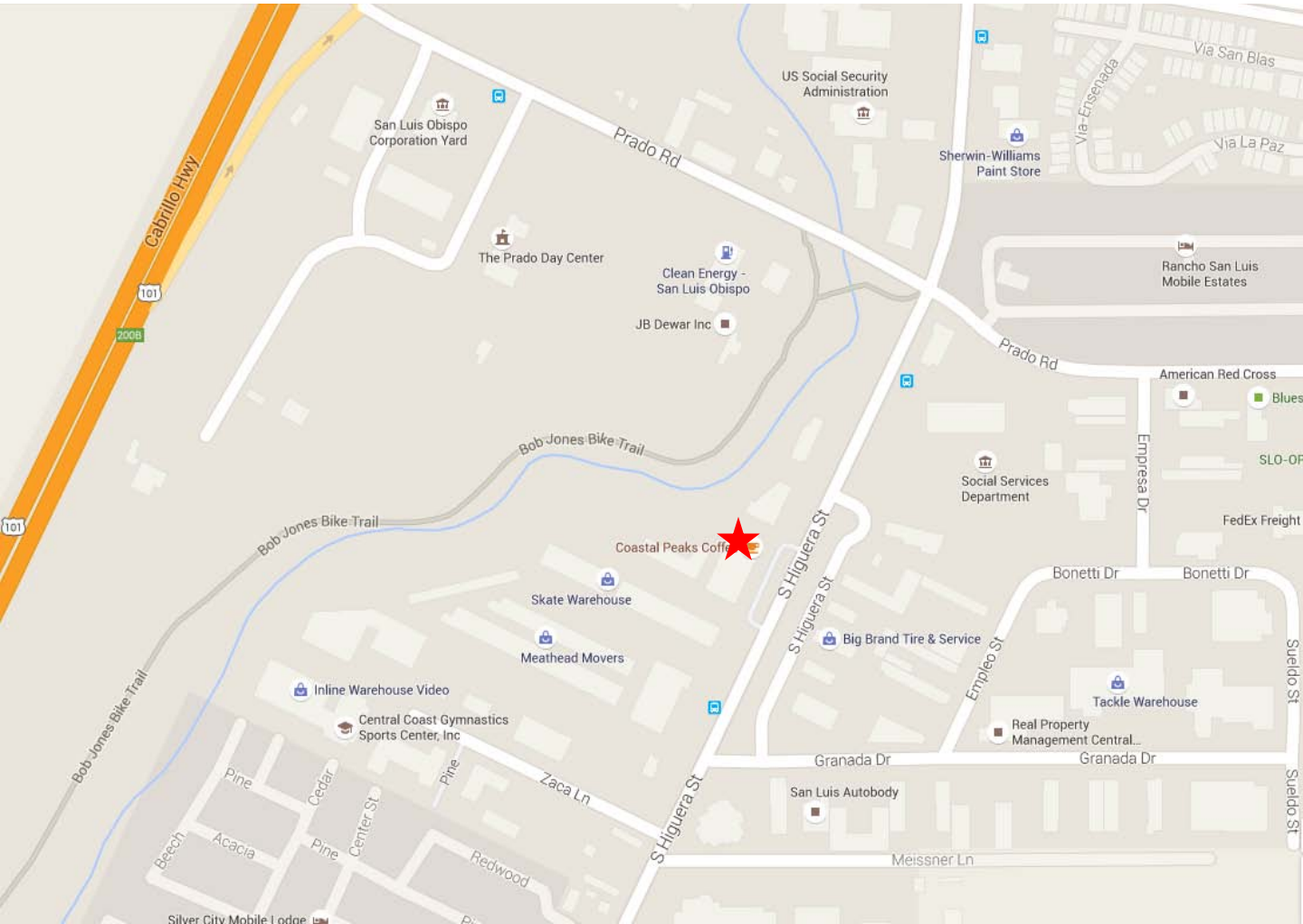

1301 Chorro Street | San Luis Obispo, CA 93401 | tel 805.544.3900 | www.rossetticompany.com

Information contained herein has been obtained from the owner of the property or from other sources deemed reliable. We have no reason to doubt its accuracy, but we do not guarantee it.



PHOTO GALLERY

ROSSETTI
COMPANY
COMMERCIAL REAL ESTATE

Tenwise Park
San Luis Obispo

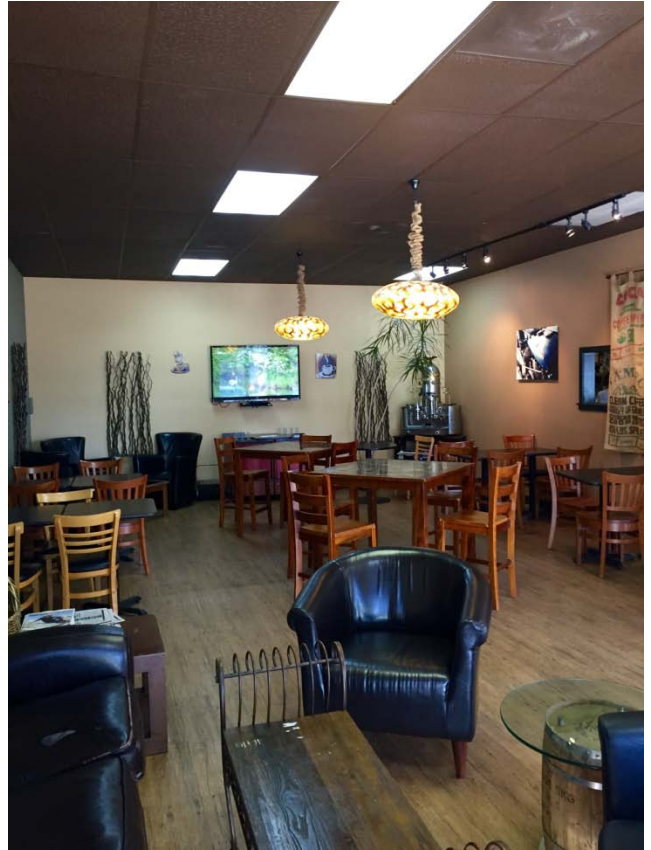

1301 Chorro Street | San Luis Obispo, CA 93401 | tel 805.544.3900 | www.rossetticompany.com

Information contained herein has been obtained from the owner of the property or from other sources deemed reliable. We have no reason to doubt its accuracy, but we do not guarantee it.

