

FOR LEASE

3,212 SF Office Space
San Luis Obispo

ROSSETTI
COMPANY
COMMERCIAL REAL ESTATE



FEATURES

Comments: 3,212 SF of newer office space located in a convenient location next door to the Trader Joe's Center, in south San Luis Obispo. Space includes a combination of hard offices and bull pen area. Very good natural lighting and views. Includes on-site parking. Easy freeway access.

Location: Tank Farm & S. Higuera Street

Price: \$1.65/SF, NNN (~\$0.40)

Type: Office

Size: 3,212 +/- sq. ft.

Zoning: CS

Parking: 9 spaces on-site



CONTACT

Preston Thomas, SIOR
805.544.3900 office
preston@rossetticompany.com
Cal BRE Lic. #01378821

CO - LISTED

Andy Maddalena
Maddalena Realty
805.543.9312 office
maddalenarealty@charter.net
Cal BRE Lic. #00863007

1301 Chorro Street | San Luis Obispo, CA 93401 | tel 805.544.3900 | www.rossetticompany.com

Information contained herein has been obtained from the owner of the property or from other sources deemed reliable. We have no reason to doubt its accuracy, but we do not guarantee it.



FLOOR PLAN

102 Cross Street
San Luis Obispo

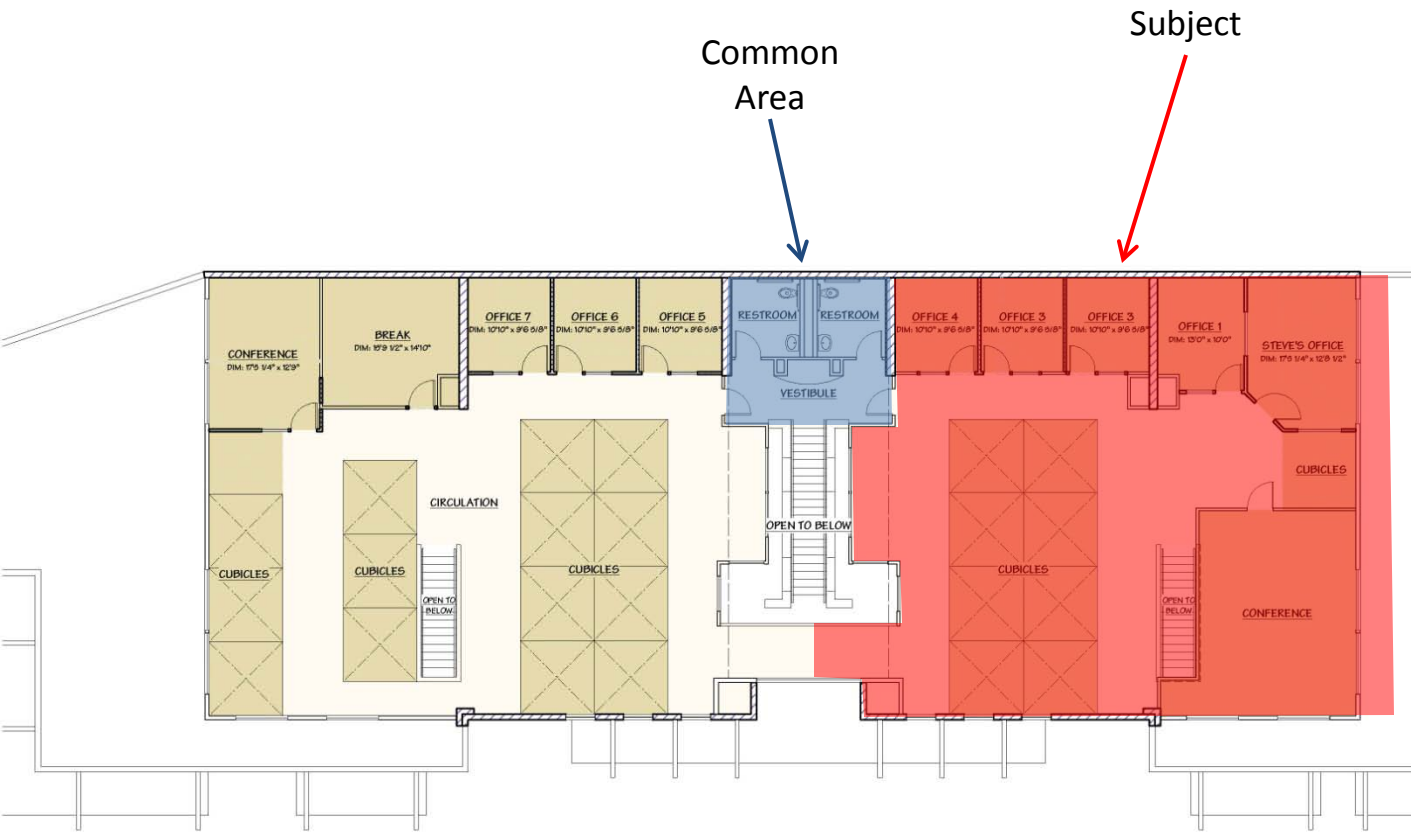

PHOTO GALLERY

102 Cross Street
San Luis Obispo

ROSSETTI
COMPANY
COMMERCIAL REAL ESTATE



1301 Chorro Street | San Luis Obispo, CA 93401 | tel 805.544.3900 | www.rossetticompany.com

Information contained herein has been obtained from the owner of the property or from other sources deemed reliable. We have no reason to doubt its accuracy, but we do not guarantee it.



PHOTO GALLERY

102 Cross Street
San Luis Obispo

ROSSETTI
COMPANY
COMMERCIAL REAL ESTATE



1301 Chorro Street | San Luis Obispo, CA 93401 | tel 805.544.3900 | www.rossetticompany.com

Information contained herein has been obtained from the owner of the property or from other sources deemed reliable. We have no reason to doubt its accuracy, but we do not guarantee it.



LOCATION

102 Cross Street
San Luis Obispo

ROSSETTI COMPANY

COMMERCIAL REAL ESTATE

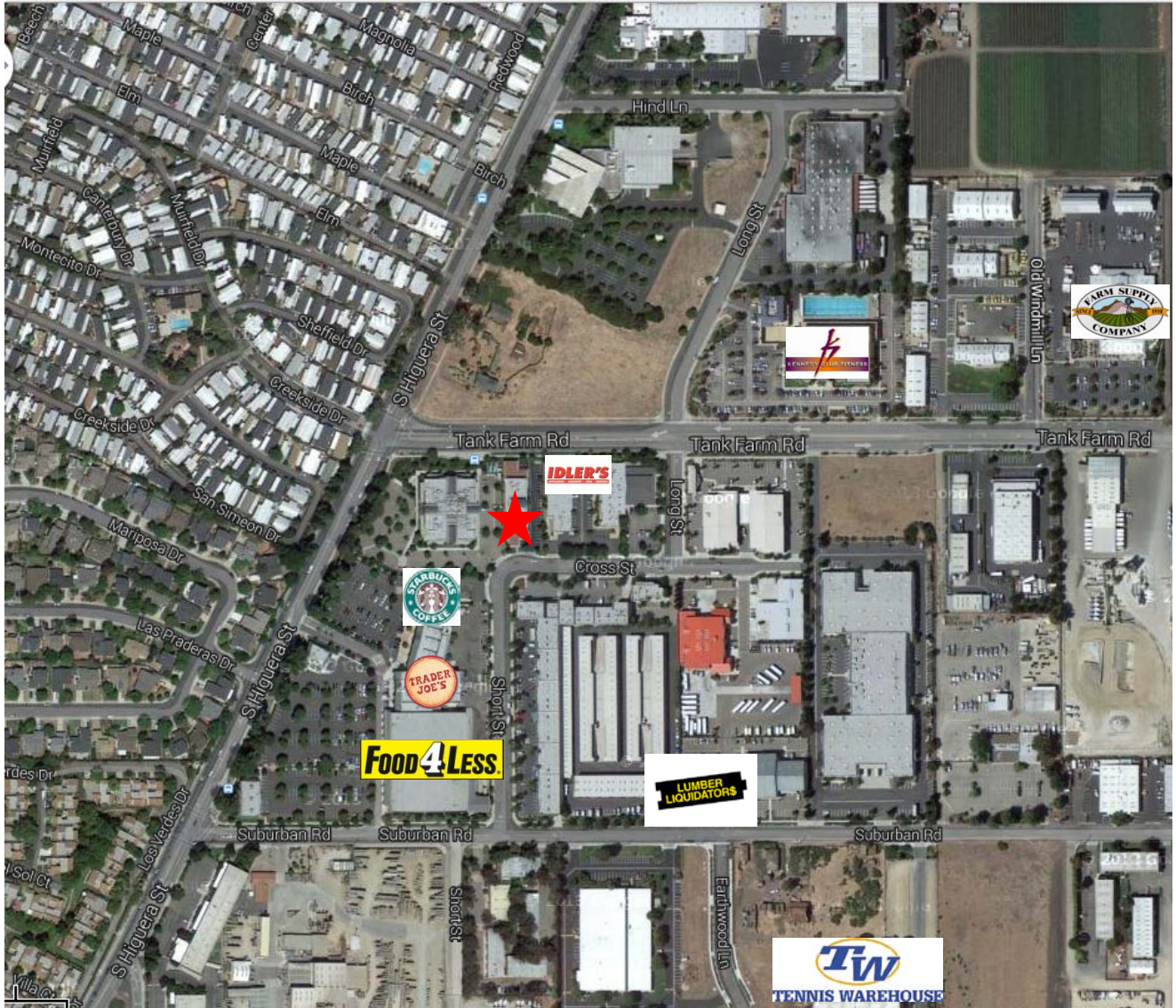

1301 Chorro Street | San Luis Obispo, CA 93401 | tel 805.544.3900 | www.rossetticompany.com

Information contained herein has been obtained from the owner of the property or from other sources deemed reliable. We have no reason to doubt its accuracy, but we do not guarantee it.

